



Detached Villa for sale in Benahavís, Benahavís

4,250,000 €

Reference: SP0722 Bedrooms: 5 Bathrooms: 5 Plot Size: 2,210m² Build Size: 605m² Terrace: 522m²



FLOOR SURFACE HOUSE	
First floor	207,66 m ²
Main floor	372,48 m ²
Entrance floor	125,46 m ²
TOTAL	505,60 m²
FLOOR SURFACE COVERED TERRACES	
First floor	152,51 m ²
Main floor	112,20 m ²
Entrance floor	147,72 m ²
TOTAL	412,43 m²
FLOOR SURFACE UNCOVERED TERRACES	
First floor	4,88 m ²
Main floor	192,21 m ²
Entrance floor	62,00 m ²
TOTAL	359,09 m²
POOL SURFACE	
Lower floor	38,76 m ²
TOTAL	14,36 m²
TOTAL FLOOR SURFACE	1.187,74 m²
TOTAL PLOT SIZE	2.210,00 m²

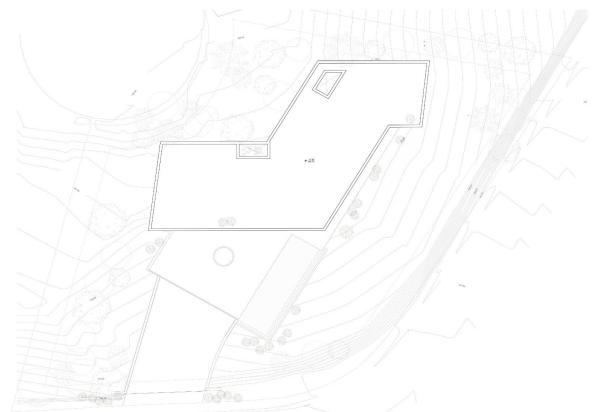



Costa del Sol, Benahavís

NEW BUILD LUXURY VILLA IN BENAHAVIS

Perched on an elevated position in the mountain foothills, New Build Luxury Villa is a masterful blend of strategic design and playful space distribution. With its back embraced by the mountain and its front opening to breath taking views.

The architecture and outdoor spaces are meticulously oriented towards the Mediterranean Sea, the castle of Monte Mayor, and the emerald valley below. From the expansive terraces to the integrated outdoor lounge area this villa offers a protected and serene haven. Every corner of this residence invites you to relax and enjoy the harmonious connection with nature.

The villa includes: 5 bedrooms, 5 en-suite bathrooms, 2 guest toilets, extensive terraces, an integrated outdoor lounge area and a stunning swimming pool. Villa radiates sophisticated charm with its use of noble materials and top-tier specifications. It achieves an ideal synergy between state-of-the-art design and ecological sensitivity, featuring a minimal environmental footprint, green roofs, optional solar energy, and landscaping designed to thrive in drought conditions.

For those who crave a refined lifestyle in a tranquil and scenic environment, villa presents a unique chance to experience luxurious living seamlessly integrated with nature.

A natural setting with magnificent views and an ideal location for this Villa close enough to the towns, beaches and amenities along the coast - secluded enough to offer a peaceful haven.

Located on the southern face of the Serrania de Ronda mountain range, Benahavís offers spectacular views and is a popular hot spot for locals and tourists alike.



Features:

Features	Energy Rating	CO2 Emission Rating
Near Schools	B	B
Garden		
Near Commercial Center		
Elevator/Lift		
Private Pool		
Number of Parking Spaces: 2		
Beach: 7000 Meters		
Double Garage		
Air Conditioning: Pre-Installed		
Double Bedrooms: 5		
Views: Sea		
Gated		
WC: 2		
Useable Build Space: 484 Msq.		
Terrace: 522 Msq.		